



JIN RONG WATCH

INSTRUCTIONS

NOTICE

- Don't open the cover by yourself.
- This watch water-resist. (Waterproof) that I don't use the bath and the watch in the shower.
- If there is water inside or drops inside the watchcase, stop wearing immediately to the warranty and repair or purchase a new parts may damage caused by corrosion.
- Avoiding in strong magnet - which which there can be being attracted back - such as jewelry affected the aspect of watch and it will be broken.
- Don't use it in freezing or freezing environment.
- Don't wear sports watch with any sport when watch start use otherwise As the case - stop the user continuously continuously with accidents and other safety the table to use to avoid the risk of the operation of the table on subject to change - (which safety to the normal category)
- Percentage use of color lights will consume large amounts of energy.
- When not in use this watch please place it in a dry place.
- Please read this instruction carefully before using the watch.
- Product function and appearance is open to general trend.

FUNCTION AND SPECIFICATION

- Standard display - hour, minute, second, month, date and week.
- 12/24-hour
- 1/10 second of chronograph
- Stopwatch (stop measuring function)
- Alarm and hourly chime function
- Memory function
- Use temperature 0°C-50°C
- Degree of accuracy: At normal temperature will not get out right
- Memory: 1024 bits
- Left of battery: Alarm to notify power for 18 months under the following condition
- One illumination per day
- One illumination per day

OPERATION

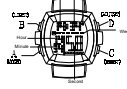

Button explain

- 1. MODE: Function select button
- 2. CORRECT: Digital entry key
- 3. CORRECT: Last Light
- 4. CORRECT: Power on/off
- 5. CORRECT: Can change every adjustment

HOW TO USE LIGHT

In any mode, hold down the button for 3 seconds, the light will be continuously synchronous light.

Press and hold down the button light will be continuously synchronous light.

HOW TO CHANGE 12/24 FORMAT

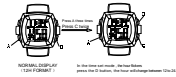

HOW TO CHECK DATE

Press and hold down the button for 3 seconds, the date will be displayed.



HOW TO DISPLAY THE ALARM TIME

In normal mode, press and hold down the button for 3 seconds, the alarm time will be displayed.

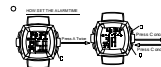

HOW TO CHECK BATTERY

Press and hold down the button for 3 seconds, the battery level will be displayed.



HOW TO ON/OFF HOURLY CHIME

In normal mode, press and hold down the button for 3 seconds, the hourly chime will be on/off.

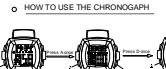

HOW TO USE THE CHRONOGRAPH

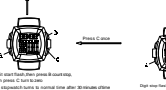

HOW TO SET TIME, DATE, WEEK

In normal mode, press and hold down the button for 3 seconds, the time, date, and week will be set.

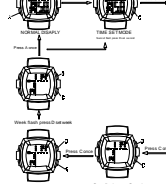

CAUTIONED

- Do not immerse in water, do not use in high temperature, do not use in high magnetic field, do not use in high voltage, do not use in high pressure, do not use in high humidity, do not use in high dust, do not use in high salt, do not use in high acid, do not use in high alkali, do not use in high radiation, do not use in high electromagnetic field, do not use in high radio frequency, do not use in high microwave, do not use in high infrared, do not use in high ultraviolet, do not use in high X-ray, do not use in high gamma ray, do not use in high neutron, do not use in high positron, do not use in high electron, do not use in high proton, do not use in high alpha ray, do not use in high beta ray, do not use in high neutron, do not use in high positron, do not use in high electron, do not use in high proton, do not use in high alpha ray, do not use in high beta ray.